

PART A**Premises Licence**

**Peterborough City Council, Environmental Services,
 Bridge House, Town Bridge, Peterborough, PE1 1HU**

Premises Licence Number

049057

Part 1 - Premises Details**Postal address of premises, or if none, ordnance survey map reference or description**

Select And Save
 9-11 Scalford Drive

Post Town Peterborough**Post Code** PE1 4XQ**Telephone Number** 01733 345852**Where the licence is time limited the dates**

Start Date N/A
 End Date N/A

Licensable activities authorised by the licence**Sale by retail of alcohol**

The supply of alcohol will be for consumption off the premises

The times the licence authorises the carrying out of licensable activities**Sale by Retail of Alcohol**

Monday to Sunday Between 06.00hrs and 22.00hrs

The opening hours of the premises

Monday to Sunday Between 06.00hrs and 22.00hrs

Where the licence authorises supplies of alcohol whether these are on and / or off supplies

The supply of alcohol will be for consumption off the premises

Part 2

Name, (registered) address, telephone number and email (where relevant) of holder of premises licence

Mr Naser Yousaf

Registered number of holder, for example company number, charity number (where applicable)

N/A

Name, address and telephone number of designated premises supervisor where the premises licence authorises the supply of alcohol

Mr Naser Amin Yousaf

Personal licence number and issuing authority of personal licence held by designated premises supervisor where the premises licence authorises for the supply of alcohol

Licence Number	047355
Issuing Authority	Peterborough City Council

Annex 1 - Mandatory conditions

Licensees should note that the under enclosed Mandatory conditions should be read in conjunction with the granted licence and these conditions shall be enforceable where relevant to the operation of the premise and its activities.

Supply of alcohol (Premises Licence)

This registration authorises the supply of alcohol subject to the following conditions:

1. No supply of alcohol may be made at a time when
 - (a) there is no designated premises supervisor in respect of the premises licence, or
 - (b) when the designated premises supervisor does not hold a personal licence or his personal licence is suspended.

2. Every supply of alcohol under the premises licence must be made or authorised by a person who holds a personal licence.

Annex 2 - Conditions consistent with the Operating Schedule

Crime and Disorder

3. Video/CCTV equipment will be set to record from the time that the premises open to the public until the premises close and all members of the public have left.
4. Notices advising that CCTV has been installed on the premises shall be posted up so that they are clearly visible to the public within the licensed premises.
5. Video/CCTV images shall be retained for at least one month and shall be produced to an authorised officer on demand.

Public Safety

6. The licence holder must ensure that the premises complies with all existing relevant Health and Safety Regulations.

Public Nuisance

7. A proof of age policy agreed by the police and local authority shall be implemented.

Protection of Children from Harm

8. Any person selling or supplying alcoholic drink under the authority of a personal licence holder must ask for a photo ID proof of age where they have reason to suspect that the individual may be under 18 years of age.

Annex 3 - Conditions attached after a hearing by the licensing authority - NONE

Annex 4 – Plans

PART B

Premises licence summary

**Peterborough City Council, Licensing Section,
Bridge House, Town Bridge, Peterborough, PE1 1HU**

Premises Licence Number

049057

Premises Details

Postal address of premises, or if none, ordnance survey map reference or description

Select And Save
9-11 Scaford Drive

Post Town Peterborough

Post Code PE1 4XQ

Telephone Number 01733 345852

Where the licence is time limited the dates

Start Date N/A
End Date N/A

Licensable activities authorised by the licence

Sale by retail of alcohol

The supply of alcohol will be for consumption off the premises

The times the licence authorises the carrying out of licensable activities

Sale by Retail of Alcohol

Monday to Sunday Between 06.00hrs and 22.00hrs

The opening hours of the premises

Monday to Sunday Between 06.00hrs and 22.00hrs

Where the licence authorises supplies of alcohol whether these are on and/ or off supplies

The supply of alcohol will be for consumption off the premises

Name, (registered) address of holder of premises licence

Mr Naser Yousaf

Registered number of holder, for example company number, charity number (where applicable)

N/A

Name of designated premises supervisor where the premises licence authorises for the supply of alcohol

Mr Naser Amin Yousaf

State whether access to the premises by children is restricted or prohibited

Restricted

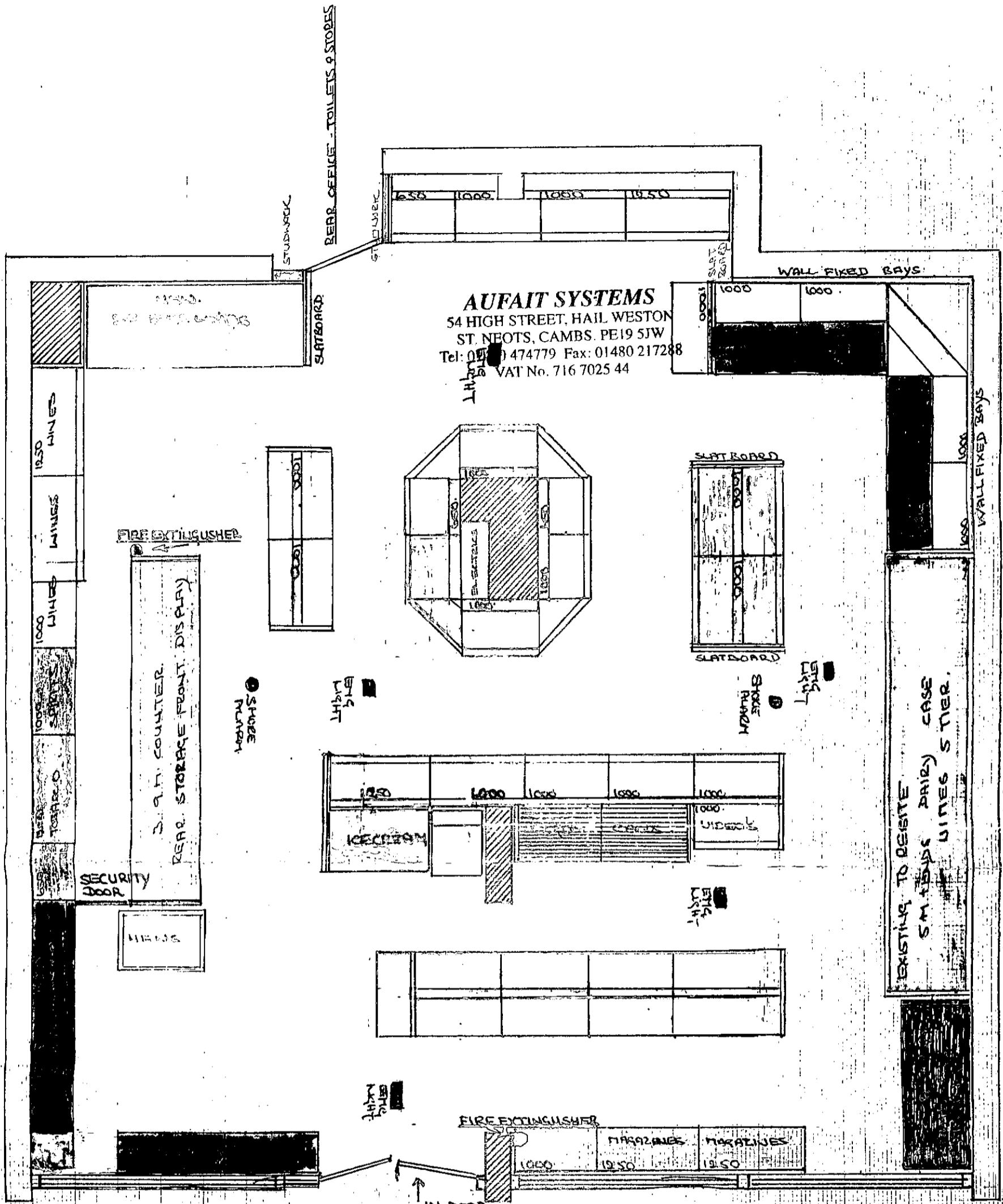

AUFIT SYSTEMS
 54 HIGH STREET, HAIL WESTON
 ST. NEOTS, CAMBS. PE19 5JW
 Tel: 01480 474779 Fax: 01480 217288
 VAT No. 716 7025 44

CARD UNIT 1800mm High

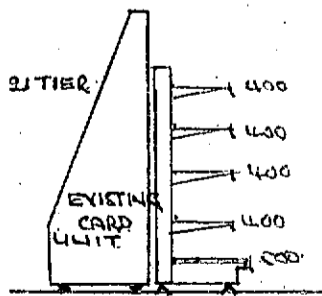

SHOP PLAN LAY OUT FOR
 9-11 SCALFORD DRIVE, WELAND,
 PETERBOROUGH PE1 4XQ
 TEL No 01733-345852
 DRAWING BY JOHN K HARRISON
 DATE: 25-2-08
 SCALE: 1:50

AUFIT SYSTEMS
 HIGH STREET, HAIL WESTON,
 ST NEOTS, CAMBS PE19 5JW

AUFIT SYSTEMS
 GLENROY HOUSE
 54 HIGH ST. HAIL WESTON
 ST. NEOTS, CAMBS. PE19 5JW
 TEL: 01480 474779
 aufaitsystems@btinternet.com
 VAT No: 716 7025 44

AUFIT SYSTEMS
 54 HIGH STREET, HAIL WESTON
 ST. NEOTS, CAMBS. PE19 5JW
 Tel: 01480 474779 Fax: 01480 217288
 VAT No. 716 7025 44

This page is intentionally left blank